

---

## Copper Cable Lug-CL



### Copper Cable lug (Australia Standard)

Powerlink copper cable lug is used to connect the copper conductor end. It has a Inspection hole to check the conductor location. Material from high conductivity annealed 99.9% copper which gives the best electrical properties possible. Tin plating process, beautiful appearance.

All cable lugs meet AS/NZS4325 standard.

### Products Advantage

1. Exquisite tin plating process, the product surface is smooth and beautiful, anti-oxidation, anti-corrosion
2. Using 99.9% pure copper, strong conductivity
3. Dimensions meet IEC standards and provide quality & quantity guarantee

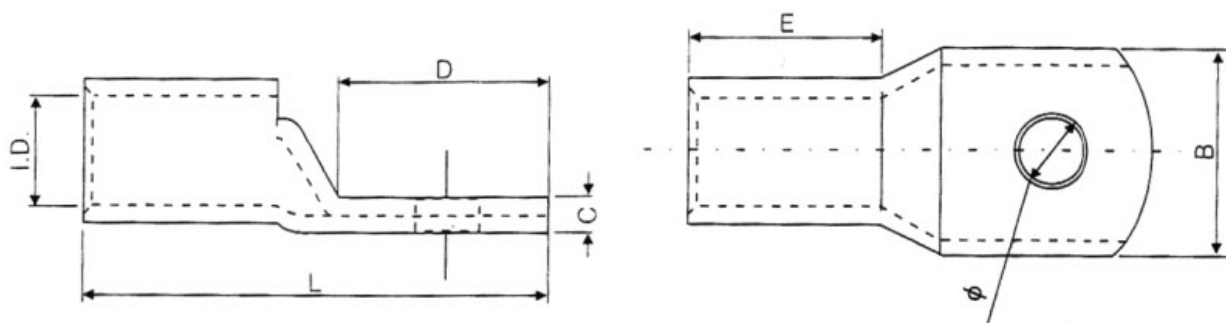

---

Product link : <https://www.baolinpower.com/copper-cable-lug-cl.html>